

M I D - T E X CATTLE CO.

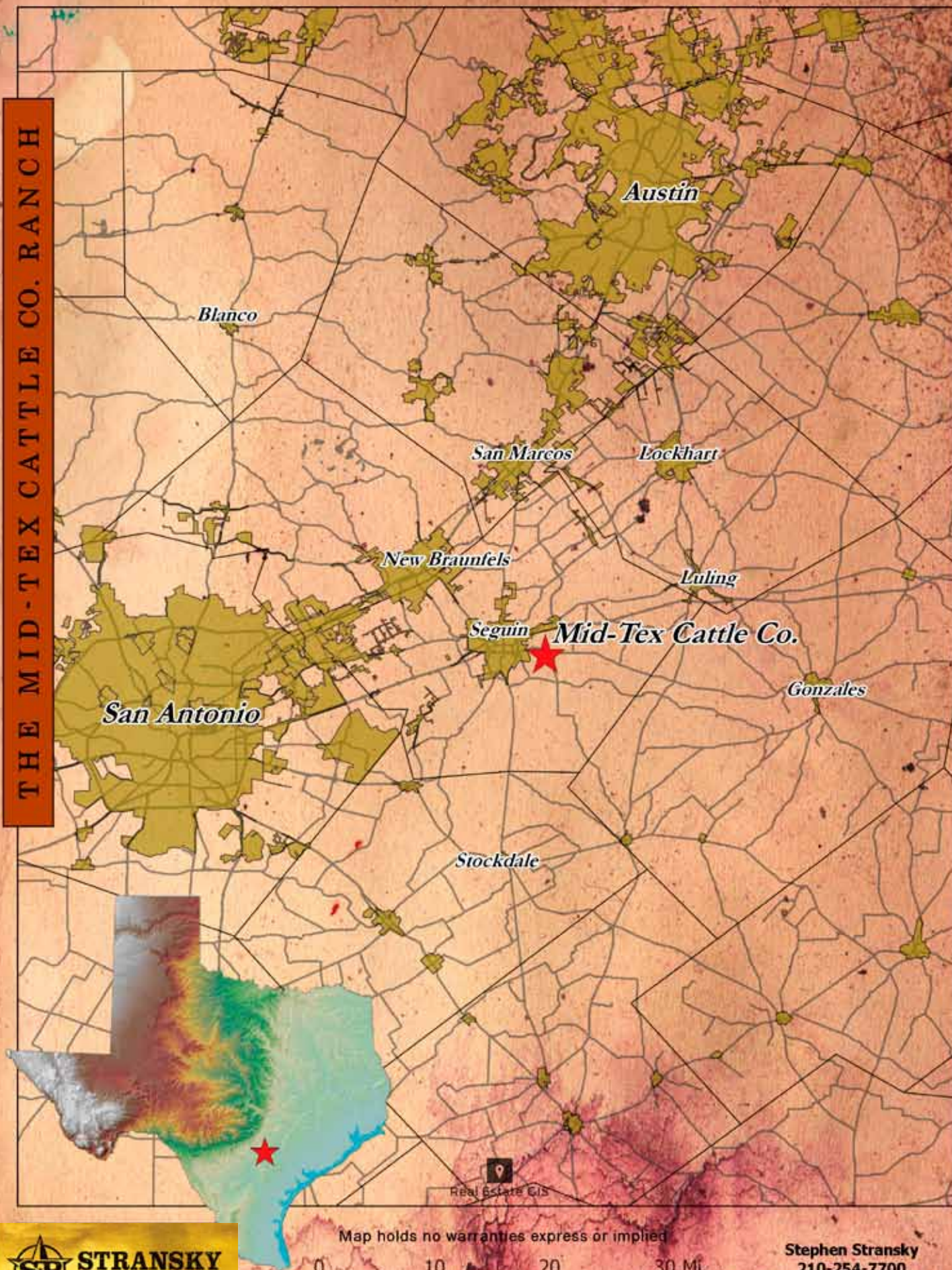

**122 ACRES
GUADALUPE COUNTY
SEGUIN, TX**

THE MID-TEX CATTLE CO. RANCH



Real Estate GIS

Map holds no warranties express or implied

0 10 20 30 Mi.



STRANSKY
PROPERTIES

Stephen Stransky
210-254-7700

stephen@stranskyproperties.com

About

- **Currently operating as Mid-Tex Cattle Company**
- **+/-122 acres**
- **Fronting on 3 roads being Hwy. 90, Biecker rd., and Weber Rd.**
- **Only 3 miles from Seguin**
- **2 private water wells & community water from two sources being(Crystal Clear WSC & Springhill Community Water Supply).**
- **Currently being used as a pre-conditioning yard for cattle with a carrying capacity of 800 head**
- **Has rent house fronting Biecker Rd.**
- **Good exterior fencing with numerous cross-fences**
- **Has both sides of wet-weather Saul creek going right through the middle of the property lined with very large trees**
- **Improved coastal hay pastures**
- **Piped water to several tanks scattered throughout the property**





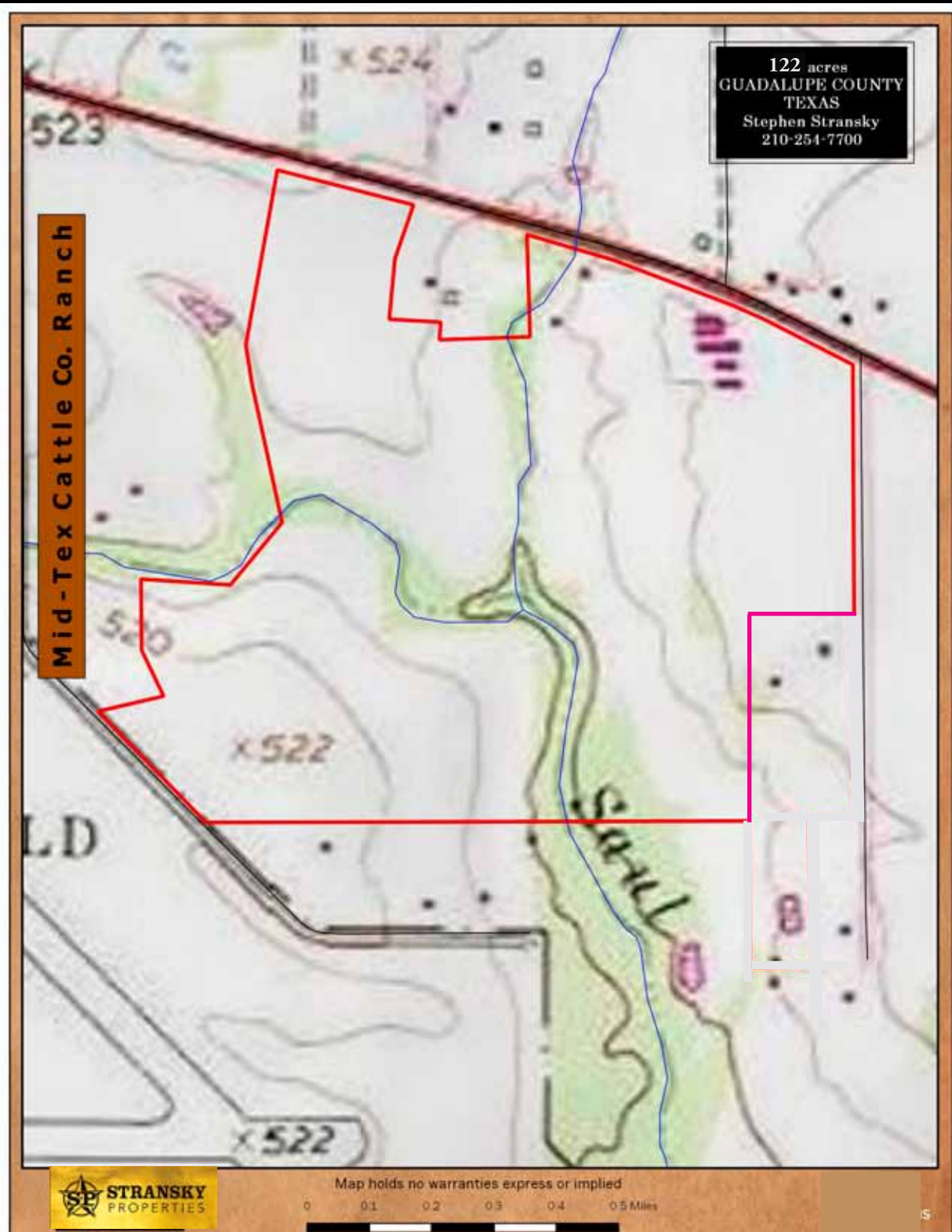

Mid-Tex Cattle Co. Ranch

~122 acres
GUADALUPE COUNTY
TEXAS
Steven Stransky
210-254-7700

FEMA National Flood Hazard Layer
Zone A - 1% percent chance flood



Map holds no warranties express or implied
0 250 500 750 1000 ft



122 acres
GUADALUPE COUNTY
TEXAS
Stephen Stransky
210-254-7700

Mid-Tex Cattle Co. Ranch

SOILS

- BrA - BRANYON CLAY, 0 TO 1 PERCENT SLOPES
- BrB - BRANYON CLAY, 1 TO 3 PERCENT SLOPES
- CfA - CROCKETT FINE SANDY LOAM, 0 TO 1 PERCENT SLOPES
- CfB - CROCKETT FINE SANDY LOAM, 1 TO 3 PERCENT SLOPES
- CsC3 - CROCKETT LOAM, 2 TO 5 PERCENT SLOPES, ERODED
- MaA - MABANK LOAM, 0 TO 1 PERCENT SLOPES
- MaB - MABANK LOAM, 1 TO 3 PERCENT SLOPES
- Tw - TRINITY CLAY, FREQUENTLY FLOODED (TINN)



Map holds no warranties express or implied

0 0.1 0.2 0.3 0.4 0.5 Miles



**STRANSKY
PROPERTIES**

